



**NEW TECH ENGINEERS**

**An ISO 9001:2015 Certified**

Complete  
**Solutions** for



**NEW TECH ENGINEERS**

An ISO 9001:2015 Certified

*Grain Processing Industry*



An ISO 9001:2015 Certified

**NEW TECH ENGINEERS**



📍 Kh. No. 1547, New 29/11, GF, Khata No. 53/1, B/h SDM Office GT Road, Village Alipur, New Delhi-110036, India

Mr. Abdulkhadir Mr. Manjur Hassan Mr. Nisar Khan Mr. Nafis Khan

📞 +91-9871161198 // +91-9359719221 // +91-9520306786 // +91-9871087270

✉️ newtechengineerspvtltd@gmail.com // enquiry.newtechdelhi@gmail.com

🌐 www.newtechengineerspvtltd.com // info@newtechengineerspvtltd.com

📺 **New Tech Engineers** 📷 **New Tech Engineers**

📍 Nigeria Office: House No. 425 Along Ring Road Nearby Star Bakery Street Yankaba Kano Nigeria.

📞 **+2347088460634 +2348093300899**

✉️ newtechengmrkt.srvcltd@gmail.com

Complete  
**Solutions** for

*Grain Processing Industry*



**NEW TECH ENGINEERS**

An ISO 9001:2015 Certified



# Registration Certificate

This is to certify that

## **NEW TECH ENGINEERS**

GROUND FLOOR, KHATA NO 53/1, KH NO. 1547 NEW 92/11, VILLAGE - ALIPUR,  
LANDMARK NEAR SHRI RAM, DELHI - 110036, INDIA.

has been assessed by RAPL and found to comply with the requirements of

## **ISO 9001 : 2015** Quality Management Systems

### **For the following activities:**

MANUFACTURING OF RICE MACHINERY, SELLA PLANT, ELEVATOR, PADDY CLEANER,  
GRADER, CHIMANI, HISTORY TRILL, LASER CUTTING MACHINE, SHEET BENDING,  
CHC MACHINE MANUFACTURING.

Certificate Number: E2023063398  
Date of certification: 26/06/2023  
1st Surveillance on or before: 25/06/2024  
IInd Surveillance on or before: 25/06/2025  
Certification Valid Until: 25/06/2026



**Director (Certification)**  
**Royal Assessments Pvt. L**

623 A, Tower-B, iThum, Plot No. A - 40, Sector - 62, Noida  
www.royalapl.com, info@royalapl.com  
Phone : +91 120 4251329

This Certificate can be verified at [www.royalapl.com](http://www.royalapl.com)



*This Certificate remains the property of Royal Assessments Private Limited. Must be returned on request or if certificate is withdrawn. Validity of this certificate is subject to successful surveillance audits. RAPL is accredited by EGAC. EGAC is member of International Accreditation Forum (IAF) and signatory of MLA.*



[www.newtechengineerspvtltd.com](http://www.newtechengineerspvtltd.com) // [info@newtechengineerspvtltd.com](mailto:info@newtechengineerspvtltd.com)



## ABOUT OUR COMPANY

We are the team of Experts in the field of Process & Technology, Project Engineering, Product Development, Project Management delivering under New Tech Engineers.

New Tech Engineers is the lead for Design & Building of Grains & Food Processing Machineries & Related Accessories. It is active in Design & Project Consulting, Project Feasibility Reports, Audits, Speciality Projects, Trading of Colour Sorter/ Bagging and Packing Machines/ Weigher/ Single machines required for various applications Grains/ Cereals and Snack food industry.

## OUR MISSION

Our purpose is to create brighter lives for people of today and generations to come!

We connect our unique competences in Grains and Food Processing to create solutions that nourish, protect and improve Health & performance.

## OUR STRENGTH

- 👉 We work as one team – Client and New Tech Engineers
- 👉 We practice the Good Project Management Principles
- 👉 We have all services disciplines under one roof - Architecture, Civil & Structural, Process Engineering, Mechanical Engineering, Electrical Engineering, Plumbing, Fire Fighting and Life Safety systems, Environmental Engineering.
- 👉 We have delivered projects and we know the pains & problems of delivering a project successfully



“ We stay, support and work together with the client till the end ”



## OUR VISION



### Product and Process Innovation

*Development of new processes with aim to reduce processing time, increase productivity, and maximize yield.*



### Efficient operation with IOT

*Diagnosis, Data Acquisition, Production reporting, Real time data management.*



### Bi Product Utilization

*Value creation in process steps - Product and ByProducts.*



### Energy Optimization

*Energy efficient process makes less energy to perform the same task or produce the same result.*

## OUR EXPERTISE

- Project Management
- Procurement Management
- Commissioning Support
- Concept & Basic Engineering Design (Plant and Process)
- Detailed Engineering Design
- Project Construction Management
- Qualification & Validation Support

## Key Business Area

The following Process will help customers to optimize their business processes and create value additions through innovations and ensuring sustainable growth.

Flour Meal Processing  
Paddy/Rice Processing  
Pulses Processing  
Spices Processing  
Wheat & Millets Processing  
Sesame Processing  
Oil Plants  
Co Gen Power Plants  
Animal Feed plants  
Other Grain Processing





## e Cleaner

The Annapurna Cleaner (AC) is a universal machine which is well suited for pre cleaning of many different species of grains & heavy seeds. It is also ideal to dress malting barley & milling grain to the highest quality. It has a very good influence in India & Abroad also.

### Features

1. Top mounted Air extraction unit for best aspiration.
2. Stepless variable air controls.
3. Easily changeable sieves with large surface area
4. As the machine is dynamically balanced hence there is no vibration.
5. Specially designed rubber balls/beaters to check sieve perforation clogging.

## Plan Sifter

It is indented cylinder screen type it separates broken or shorter grain from whole grain by length. This machine efficiently separate broken rice and head rice from raw rice, steam rice, parboiled rice and basmati rice.

### Features

1. Maximum Sieve Surface area.
2. Sieve frames of synthetic-resin-coated wood.
3. Highly accurate Grading of the product.
4. Easy to adjust the Sieve sizes and flow of product.
5. Removal of Bran from wheat flour.
6. Grading of clean and hygienic Flour in Wheat Flour mill, Maize mill, Rice Mill etc



## Bran Centrifugal

Bran Centrifugal has advanced operating systems. It is designed with the assistance of innovative technology. Our rice bran centrifugal has good separation capacity. It is widely used for cleaning of wheat, seed, paddy, rice, pulses, granular plastic iron powder & copper powder.

### Features

1. Available in different mesh sizes.
2. High yield
3. Compact structure
4. Smooth operation
5. Flexible designing
6. High quality screens





## De-stoner

The New Tech Engineers De-stoner remove stone iron particles, mud, dust and impurities etc. This machine performs on the basis of density difference by adjusting the aspiration.

### Features

- Low maintenance, precious separation of stones.
1. Compact design closed dust aspiration system.
  2. Imported Vibro Motors for trouble free, long life and low maintenance.
  3. Rigid and heavy duty Construction

New Tech Engineers machine can separate the oversize and under size impurities from the grains. Classifier also used grading the difference size of grain.

### Features

The inbuilt cleaning system to be provide for efficiency production.

1. High separating efficiency.
2. Robust construction with low maintenance, requirement.
3. Easy sieve removing.
4. Easy inspection cover remove and simple motor alignment.



## Pneumatic Rubber Sheller

The NTE rubber Sheller is completely automatic system ensures correct feed rate and pressure between rubber rolls which reduce the rubber roll consumption and lower broken percentage.

## Features

High efficient de husking for Boiled, Raw, Steam & Basmati Rice

1. FEEDER: The vibrator feeder provide in the colour sorter is introduce. It simultaneously provides smooth, consistent and high throughput put. It is quipped with a feeder volume control which can vary the flow rate in a continuous linear manner.
2. CHUTE: The new chute is designed to automatically controlled in the best orientation. It maintain the paddy on the chute in a uniform and consistent feed.



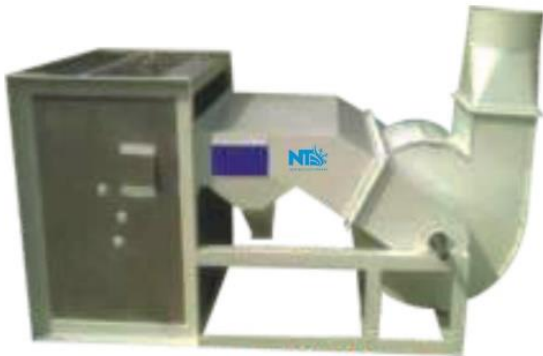

New Tech Engineers Husk aspirator are used for aspirate husk / light particles from the product steam.

### Features

1. In-built fan for husk separation
2. accurate separation
3. Low maintenance

## Paddy Separator

The New Tech Engineers Paddy Separator mainly designed for high capacity and efficiency separate paddy and brown rice.

### Features

Low maintenance, precious separation of stones.

1. Tray type.
2. Separations of three distinct classifications Paddy brown rice and mixture.



## Whitener

Rice whitener is used for whitening a brown rice. It uses vertical abrasive grinding wheel top to bottom working principle.

A specially designed aspiration system takes away the bran produced during whitening process.

It is equipped with a mechanism for adjusting degree of whiteness.

### Features

High efficient de husking for Boiled, Raw, Steam & Basmati Rice

1. Equally milling higher yield rice with low broken.
2. It can handle Raw, Steam and Parboiled rice.
3. Ensures whiteness on all grains.
4. Heavy duty construction.
5. Low Maintenance cost.







## Silky Polisher

is used for polishing rice surface by spraying water through mixing chamber and by creating friction among rice grains using milling rollers. The weight controlled outlet of the silky polisher controls the retaining time of kernels inside the milling chamber. The water Jet Silky polisher produces rice grains with a shiny surface finish.

### Features

1. This silky polisher machine design of water dosing mechanism.
2. Specially designed milling rollers for higher glazing.
3. Easy for cleaning and lower maintenance.
4. Water & air mist nozzle at shaft.

## Length Grader

It is indented cylinder screen type it separates broken or shorter grain from whole gain by length. This machine efficiently separate broken rice and head rice from raw rice, steam rice, parboiled rice and basmati rice.

### Features

1. Modular construction of cylinders one above the other to save space.
2. Easy maintenance and minimum operating cost.
3. Inbuilt Self-Cleaning mechanism to ensure optimum separation.



## Thin Grader

This machine is used to separate different thickness grains in brown rice / polished rice. the material is passed through revolving cylindrical screens, for separating over or undersized grains. Highly efficient for separating admixture of over size or under size grains. This can also be used to separate immature grains, broken etc.

### Features

1. Suitable for both brown & white rice.
2. Efficient machines for sizing paddy & other cereals
2. Compatible with cater day screen.  
Similar setup for removal of over sized & under sized grains.





## Z Type Bucket Elevator

The Bucket Elevator is designed to lift various materials up to the delivery position at the top of the machine. The buckets are suspended in continuing hollow chains that are pulled by a gear motor installed at the top horizontal arm and located on the outside of the steel plates. The material inlet is located at the lower horizontal arm and is consisting of a vibration feeder and brushing devices that provide continuous and consistent flow of the material to the buckets. The unit is mounted with inspection hatches for service and maintenance. There is a draw in the lower section allowing for easy cleaning.

## Bucket Elevator

New Tech Engineers Bucket Elevators are mainly used in Rice Mill, Dhal Mill & Flour Mill. Elevators are equipped with some of today's most innovative features for maximum efficiency, performance and easy operations. Highly corrosion resistant and standardized with a powder coated finish for long lasting durability and superior appearance. This bucket elevators will provide years of reliable operation for a variety of grain delivery requirements.

The company is committed to the quality and believe in conceiving new ideas with extensive research and development to cater over changing requirements of clients.



## Screw Conveyor

It is used for conveying various arrays of bulk materials. Our screw conveyor allows midway discharge of material at different given points. Our trough is entirely dust proof, which is made by covering it with quality metal located in the screw conveyor. Capable of providing bulk materials to its destination, it can also transport semi-moist and fibrous materials. Our firm provides screw conveyors, which may have one or two shafts and can be inclined or horizontal as per the requirement of our clients. Our screw conveyors are widely applied in a movement of grains, cereals and hot liquid in a proficient way.

## Belt Conveyor

New Tech Engineers conveyors are accurately designed and engineered under the guidance of our professionals using high quality raw material and advanced technologies.

These rugged and sturdy build flat belt conveyors are widely used for long assembly line operations, testing, sorting, inspections and packing. In order to meet the requirements of customers, these flat belt conveyors can be floor-supported or ceiling-hung.

It is in very Convenience, Low maintenance, Highly energy efficient, Simple in construction and Lightweight





## Chain Conveyors

Chain Conveyors are varied and suitable for a wide range of purposes. Chain Conveyors allow Bulk material to be moved smoothly and economically. Material are handled gently, creating a fluid conveyor system which can move horizontally, vertically and around bends. Chain conveyor is used to transport grain as horizontally. It has different models according to capacity, usage and product type. Optionally, polyethylene or abrasion proof steel plate can be coated on bottom and side sheets of conveyors for long life-span.

Its installation is very easy due to bolt&nut connected also, technical service and maintenance are fast and easy.

## Sidewall Belt Conveyor

Sidewall Belt Conveyors are best suited for horizontal, sloping or vertical product transport. A special rubber belt with corrugated sides, individual pocket design and (depending on version) lateral non-profiled edges can convey almost every kind of bulk material and is controlled by disc rollers, drums or sloped rollers.

This belt conveyor is equipped with a precision motor, conveying belt, and other electrical parts, which make this equipment reliable and highly demanded in the marketplace. Owing to its strength and sturdiness, this conveying system does not degrade in quality or performance for the years.



## Screw Conveyor

Our Flexible Loader and Unloader conveyor are low cost and portable solutions. This is an efficient, fast and an economical solution for loading and unloading of packages from trucks and Containers. Roller conveyor segments can be extended to three times its length.

Truck Loading System is reckoned for its sturdy composition, high strength, excellent quality, durability, and low maintenance features. We provide the Truck Loading System in different customized form also.

We endeavor to offer a range that is high on performance and low on maintenance.

## SS/Plastic Foodgrade Conveyor

Optimizing latest technology, we are engaged in manufacturing a qualitative range of Modular Belt Conveyor. Based on the food application, conveyors can be customized by size, belt type, and configuration.

Modular SS Belt Conveyor are incorporated with the features of heavy loads accumulation, constructed from best quality components, sturdy construction, optimum performance and long working life.

Modular SS/Plastic conveyors provide a valuable level of versatility key for food production needs.





**NEW TECH ENGINEERS**  
An ISO 9001:2015 Certified

## Machine Layout

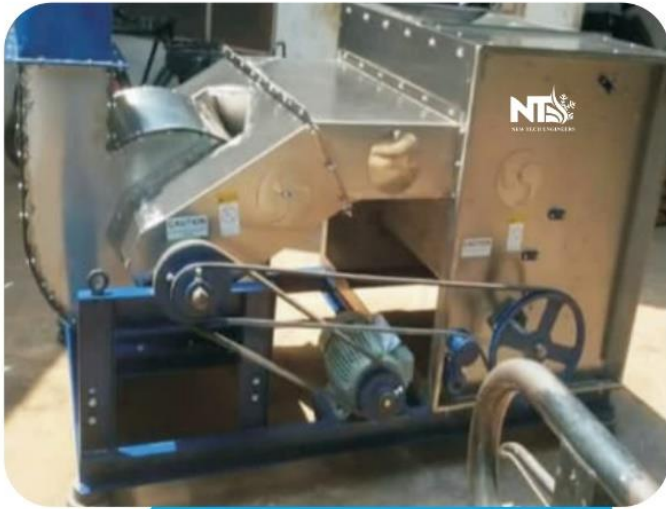

**Husk Aspirator**



**Water G.T.M**



**Water Damphner**



**Magnet**



**Mixturo Machino**



**Grain Grading Plant**





**NEW TECH ENGINEERS**

An ISO 9001:2015 Certified

## Machine Layout



**Rice Grador**



**Destoner with Fan**



**Motorise Slide Gate**



**Mana Horizontal Cyclone**





**NEW TECH ENGINEERS**

An ISO 9001:2015 Certified

## Machine Layout



**Belt Conveyor**



**Belt Coveyor**



**Truck Loader**



**Truck Loader**





**NEW TECH ENGINEERS**

An ISO 9001:2015 Certified

## Machine Layout



**Laser Cutting Machine**



**CNC Banding Machine**



**Elevator Bottom**



**Elevator Top**



**De Stoner Yan Mark**



**Bran Filter**





**NEW TECH ENGINEERS**  
An ISO 9001:2015 Certified

## Machine Layout



**Magent**



**Magent**



**Dust Collection Cyclone**



**Heavy Duty Chakki**







**Mini Plansifter**



**Round Shifter**



**Atta Packer**



**Vibro Feeder**





**NEW TECH ENGINEERS**  
An ISO 9001:2015 Certified

## Machine Layout



**Pneumatic Slide Gate**



**SS Pneumatic Slide Gate**



**Pneumatic Divertor**



**S.S Pneumatic Divertor**





## Machine Layout



**Air Lock**



**Impact Pulvisor**



**Whoat Scorer**



**Impact Pulvisor**



**Bin Dish Charge**



**Ribbon Blender**





**NEW TECH ENGINEERS**  
An ISO 9001:2015 Certified



**Husk Blower**



**Centifugal Fan**



**Chain Conveyor**



**Chain Conveyor**



**Da Stoner**



**Vibro Seprator MTRA**





# AIRLOCK

Airlock, Cyclone and Blower system is utilised for aspiration and dust collection in rice mill, dhal, wheat & flour mills etc.



**NEW TECH ENGINEERS**

An ISO 9001:2015 Certified

# MAGNET

Magnets are utilised for collecting iron particles in rice, dal, wheat etc.



# CYCLONE

# BLOWER





**NEW TECH ENGINEERS**  
An ISO 9001:2015 Certified

## Machine Layout



**Vibro Aspiration Channel**



**SS Pneumatic Slide Gate**



**Spouting**



**Machinery Hopper**





# Mill Spare Parts



SPOUTING



UNIVERSAL ELBOW



ELBOW SEGMENTS



"Y" BRANCHES



"Y" BRANCHES



DIVERTER VALVES



CONICAL TRANSITION



TRANSITIONS



INSPECTION SPOUT



AIR LOCK



BLOWER



CYCLONE





## ELECTRIC PANEL BOARD

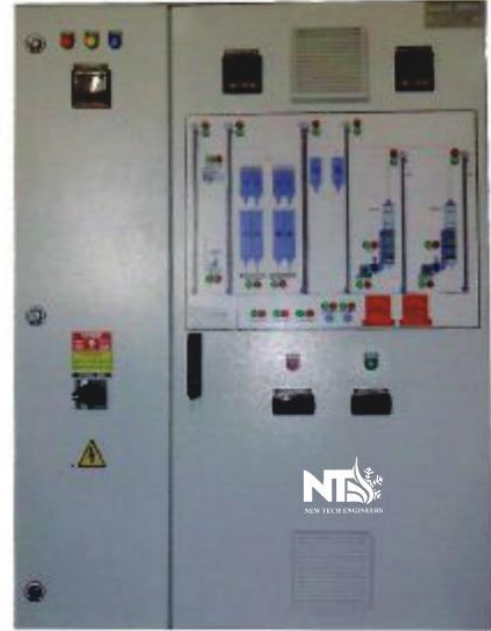

## PNEUMATIC RUBBER SHELLER

### Features;

**1. A feeder Vibrator is provided to sort different colors of rice (Newly Introduced!!)**

**Equipped with feeder volume control - Consistent flow rate**

**Newly designed Chute - A unique Slide with PLC Control ensures that Paddy is fed exactly in between the Rubber Rolls.**







## Machine Layout





# Machine Rice Mill





**Machine Rice Mill**



**Flour Mill Machinery  
 Spare Parts**  
 Grain & Pulses Engg. Pvt. Ltd.



<p><b>Reverse Air jet Filter</b></p>	<p><b>Handling Equipment</b></p> <p><b>Bindischarger</b></p>
	<p><b>Powder Feeder</b></p>
<p><b>Duck Type Aspiration Channel</b></p>	<p><b>Bucket Elevator</b></p>





# Parboiling Plants & Dryers

Parboiling of paddy is a hydrothermal process in which the starch granules in the rice are gletinized by the application of steam and hot water. This process offers several advantages such as increased yield of head rice, increased shelf life of the grain, resistance towards fungus, rodents and insects, improved nutrition of rice. The term parboiling (also known as boiling or overheating hydrothermal rice treatment) covers the operation to which the paddy is subjected before milling. Water and heat are the two main elements in the process after steeping followed by heating, which involves the action of steam. The rice must be dried before milling and storage. Rice is one of the most important food crops of India in term of both area, production and consumer preference.

## Drier's available in:

Drier's available in  
16 Tonne to 40 Tonne per batch

## Parboiling Plant available in:

Parboiling Plant Single Stage  
Parboiling Plant Double Stage  
Parboiling Plant Three Stage





# STORAGE BUNKERS

NewTech has designed, develop & Installed System for Grain (Paddy Rice, Dal & Wheat) Storage, Loading & Unloading for silo and Storage bins. We have installed systems of various capacity at many place





**FLOW CHART FOR AUTO  
COOKING PARBOILER  
WITH DRYER PLANT**

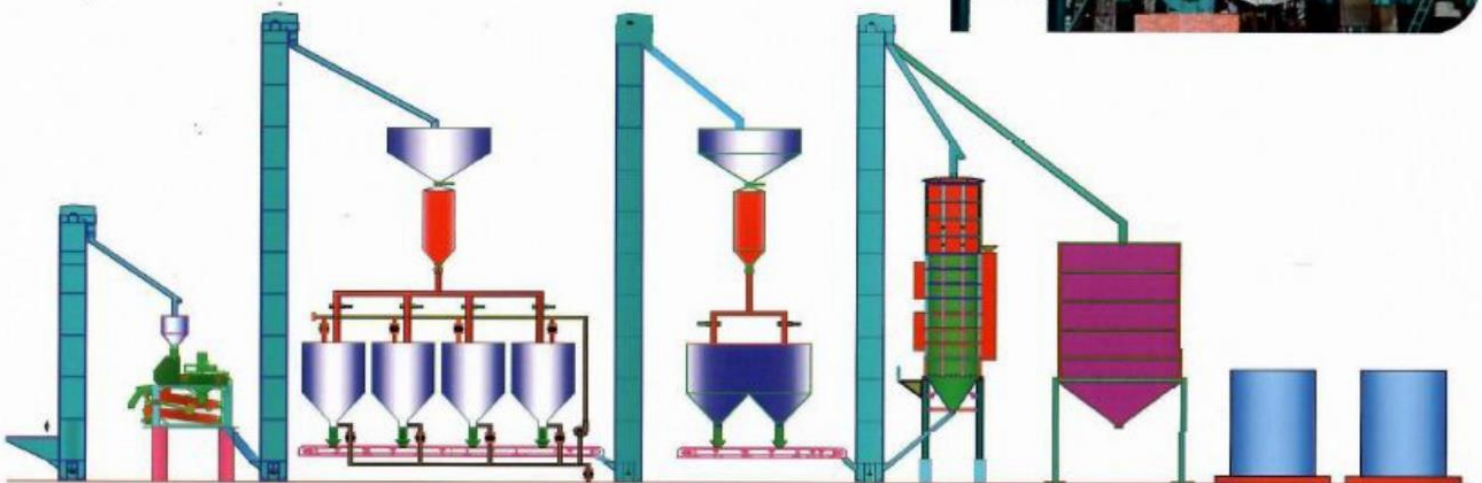



**NEW TECH ENGINEERS**

An ISO 9001:2015 Certified

## GRAIN STORAGE BUNKER





**NEW TECH ENGINEERS**

**An ISO 9001:2015 Certified**



[www.newtechengineerspvtltd.com](http://www.newtechengineerspvtltd.com) // [info@newtechengineerspvtltd.com](mailto:info@newtechengineerspvtltd.com)





**NEW TECH ENGINEERS**  
An ISO 9001:2015 Certified





## PADDY DRYER PLANT

### FEATURE

Stainless steel plants are maintenance free for minimum 10 year, and produce the hygienic rice of world class standard minimum broken with maximum production can produce

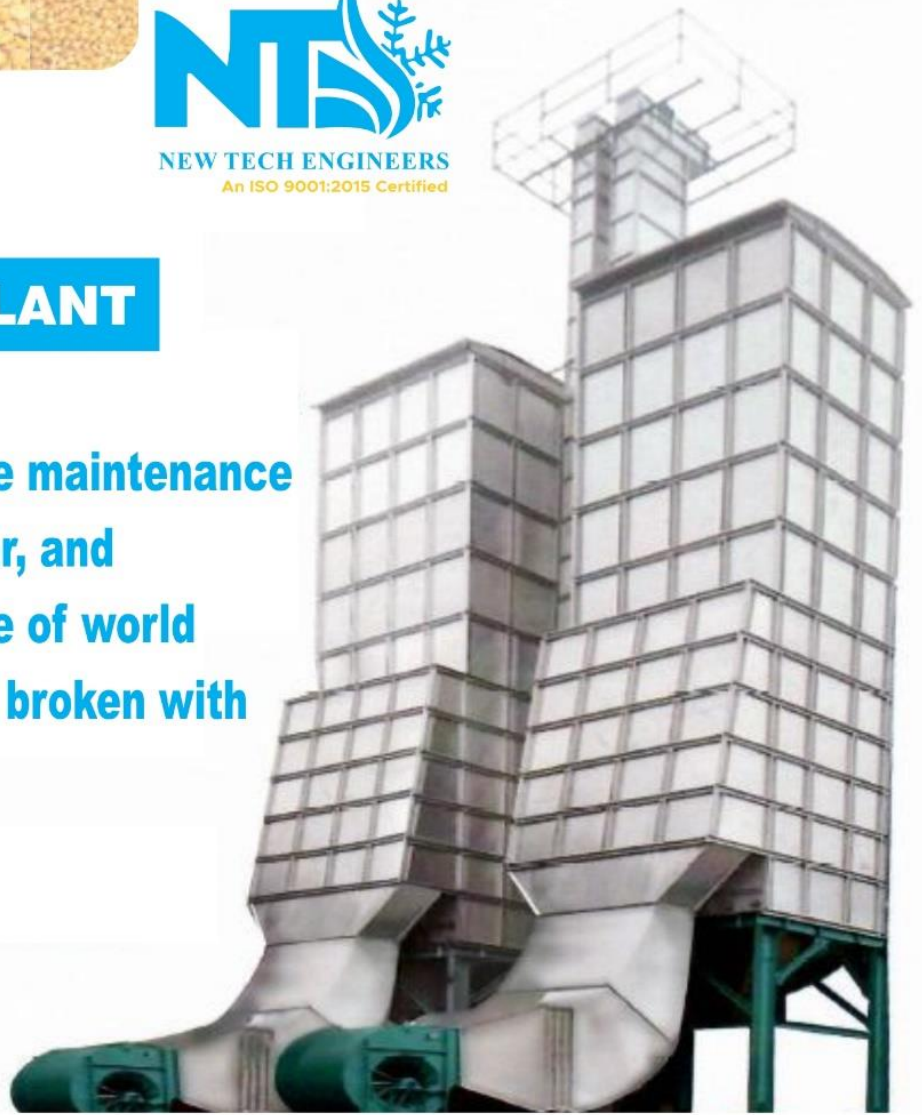

## PADDY PRE-CLEANER

GPC-800/1000/1250/1500/1750





**ATTA CHAKKI PLANT**



**RICE MILL PLANT**





# Machine Layout

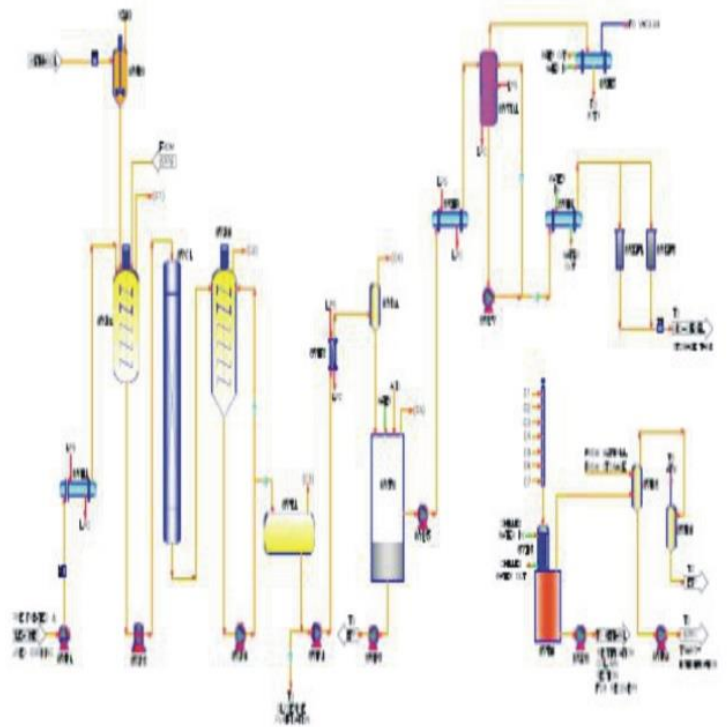
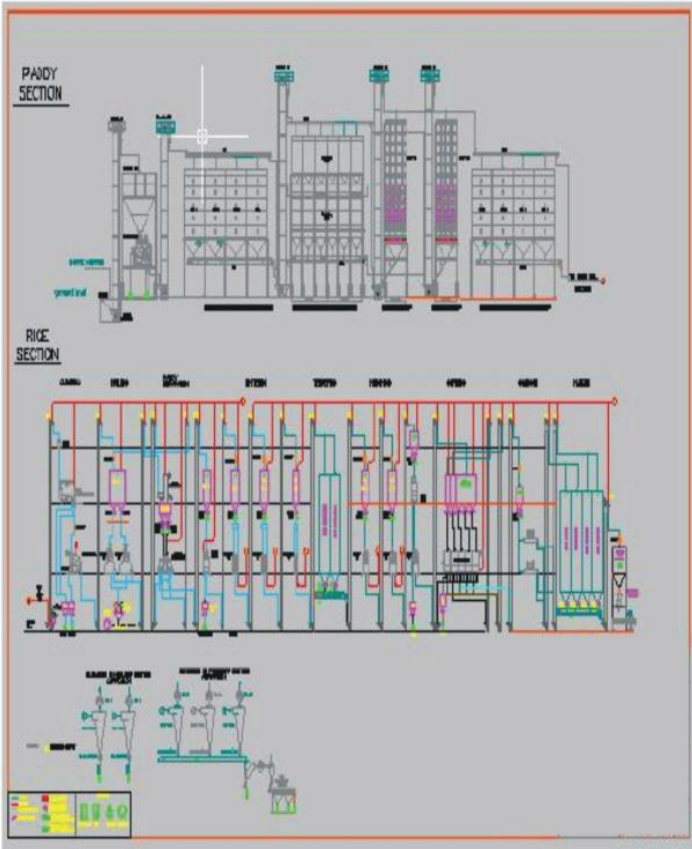



NEW TECH ENGINEERS

15 Certified





# Machine Layout





NEW TECH ENGINEERS  
An ISO 9001:2015 Certified

# Rice Mill & Dryer





**NEW TECH ENGINEERS**  
An ISO 9001:2015 Certified

## Rice Mill Plant







# Rice Mill Plant





# Rice Mill Plant





# Machine Rice Mill





## Machine Rice Mill





NEW TECH ENGINEERS

An ISO 9001:2015 Certified

# Machine Rice Mill





**NEW TECH ENGINEERS**  
An ISO 9001:2015 Certified

# Rice Mill Plant





**NEW TECH ENGINEERS**

An ISO 9001:2015 Certified

# Machine Rice Mill





NEW TECH ENGINEERS

An ISO 9001:2015 Certified

# Machine Layout

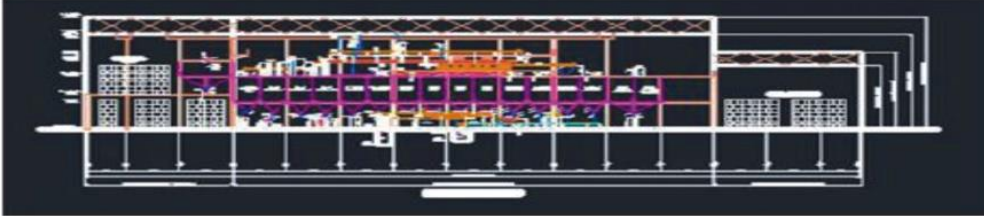
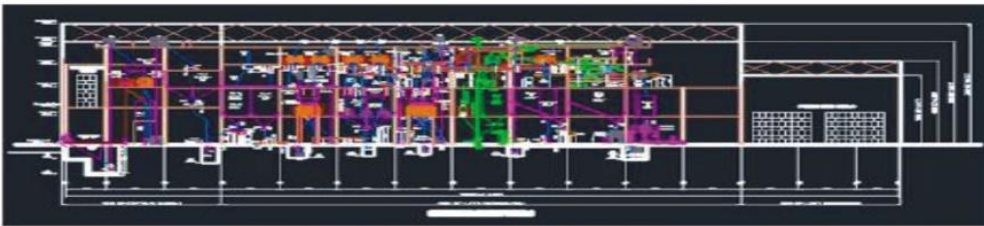
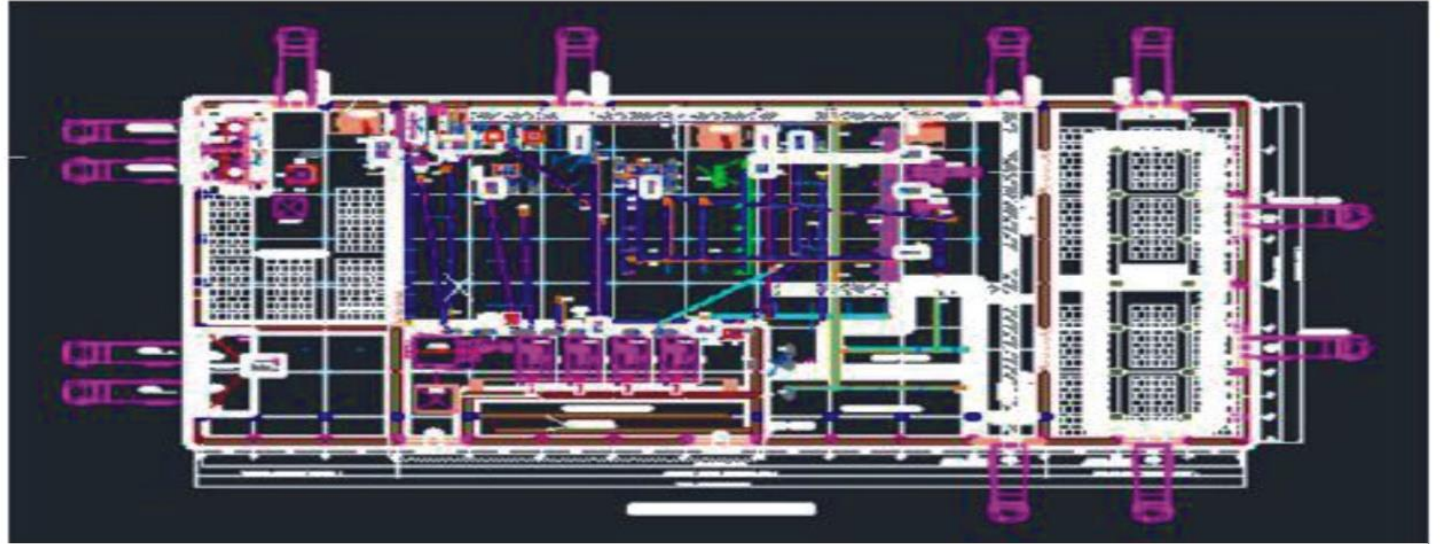
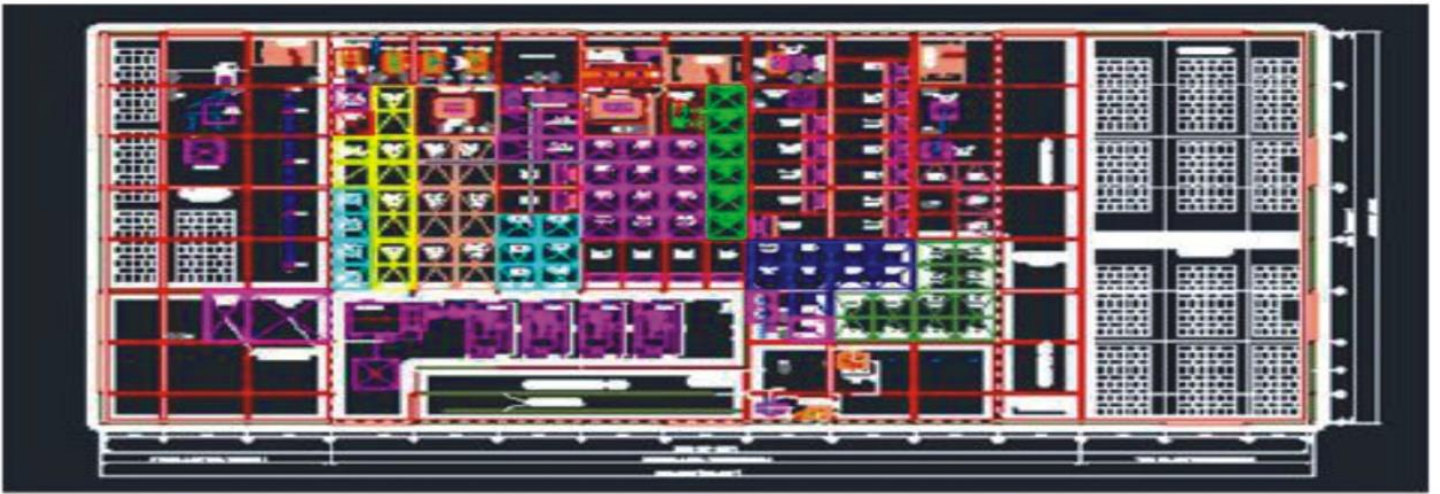





NEW TECH ENGINEERS

An ISO 9001:2015 Certified

# Projects Executed and Ongoing

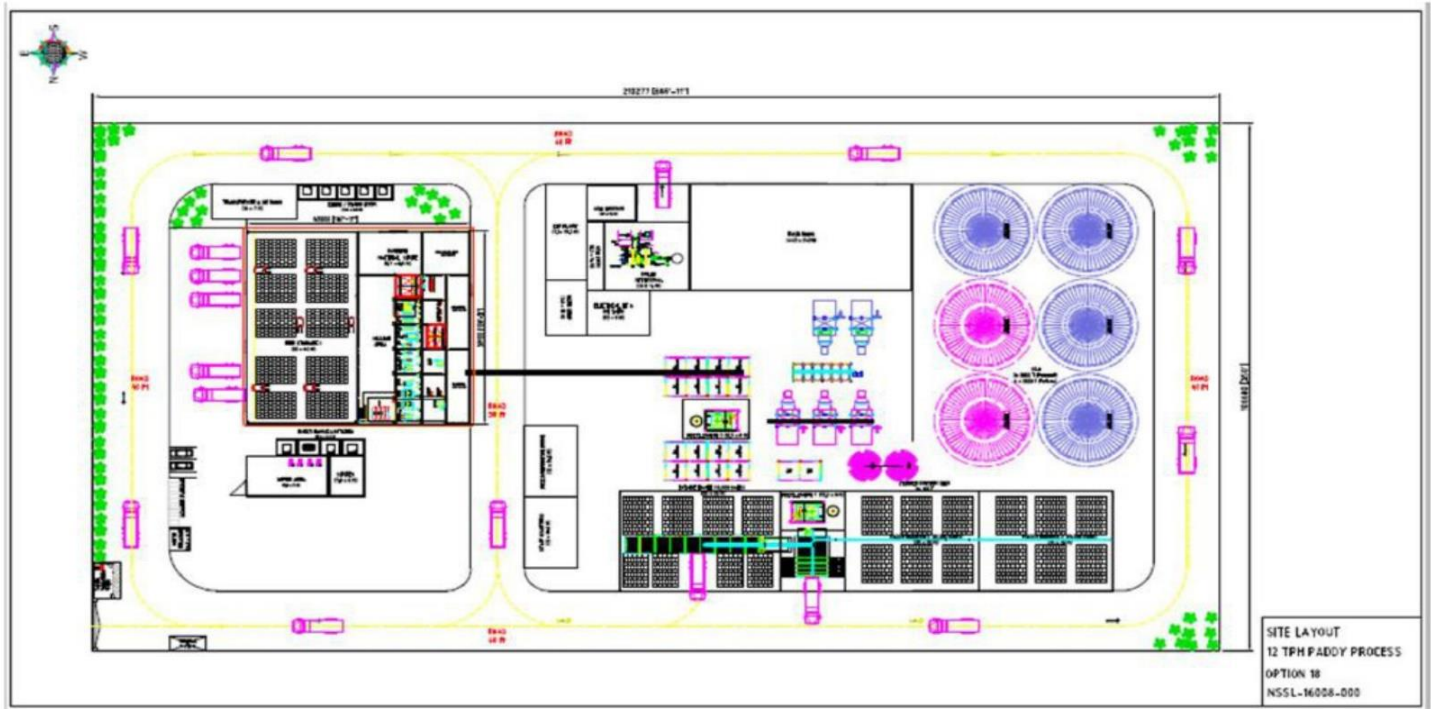

# Machine Layout

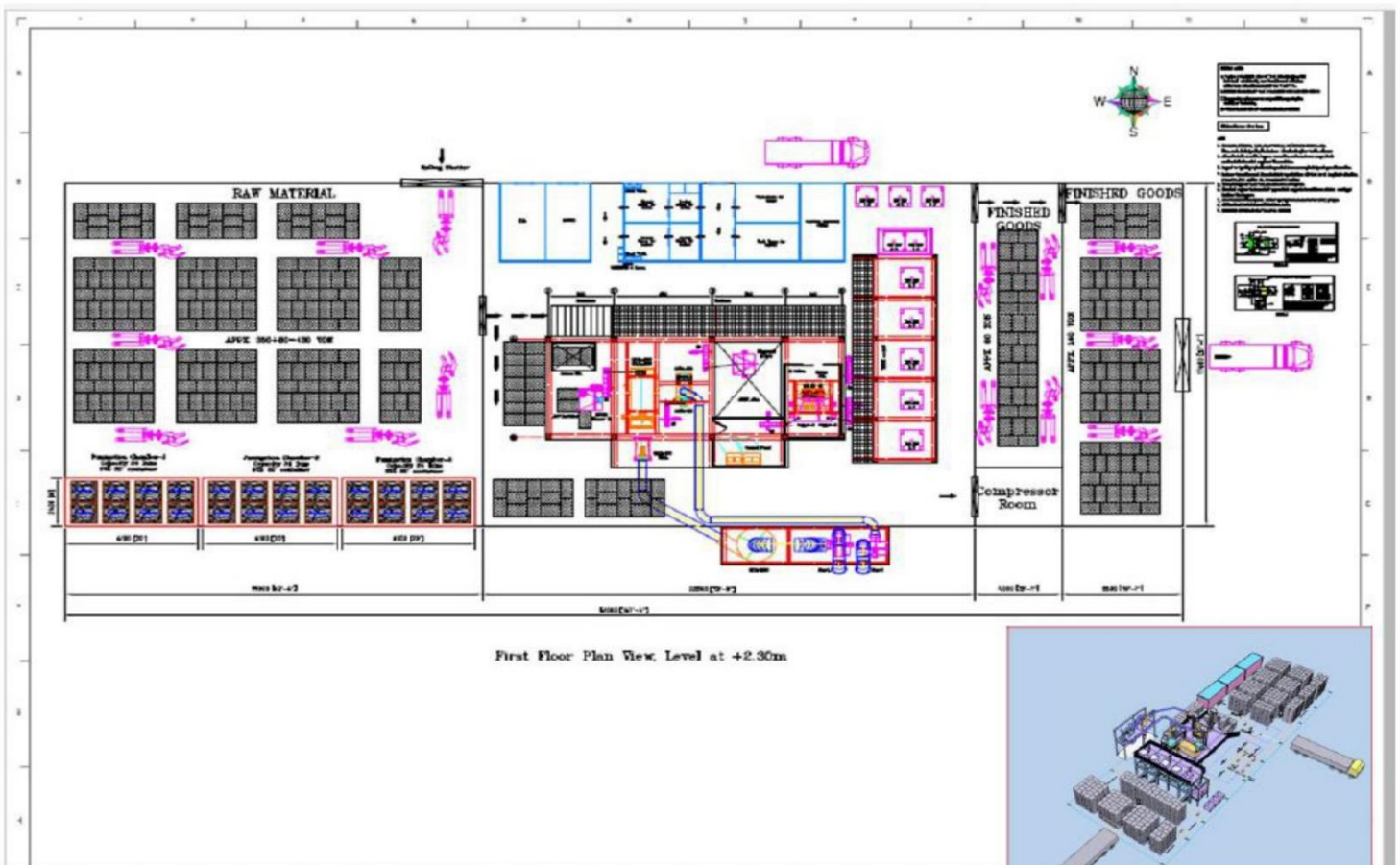



# Machine Rice Mill

QUALITY.  
COMPETENCE.  
EXCELLENCE.  
THIS IS OUR ASSURANCE.





## GRAIN PROCESSING PLANTS

Grain Processing, including cereal and pulse processing, is one of the oldest and most important of all food technologies and forms a large and important part of the food production chain. Grain pulses are grown widely throughout the world and their dietary and economic importance is globally appreciated and recognized. Today, the grain processing industry is as diverse as its range of products. Practically every meal produced contains grains in some form, while the range of non-food applications is increasing daily, all of which presents enormous processing challenges to food manufacturers.



Grain processing is essentially a physical process whereby the kernel is cleaned, adjusted to appropriate moisture content and then mechanically reduced to the desired particle size. Where appropriate it also involves fractionation - not only to separate bran, germ and endosperm from each other but also assure the correct particle size of the milled endosperm. The process involves neither chemical nor thermal treatments and thus does not bring about decontamination of the grain itself.

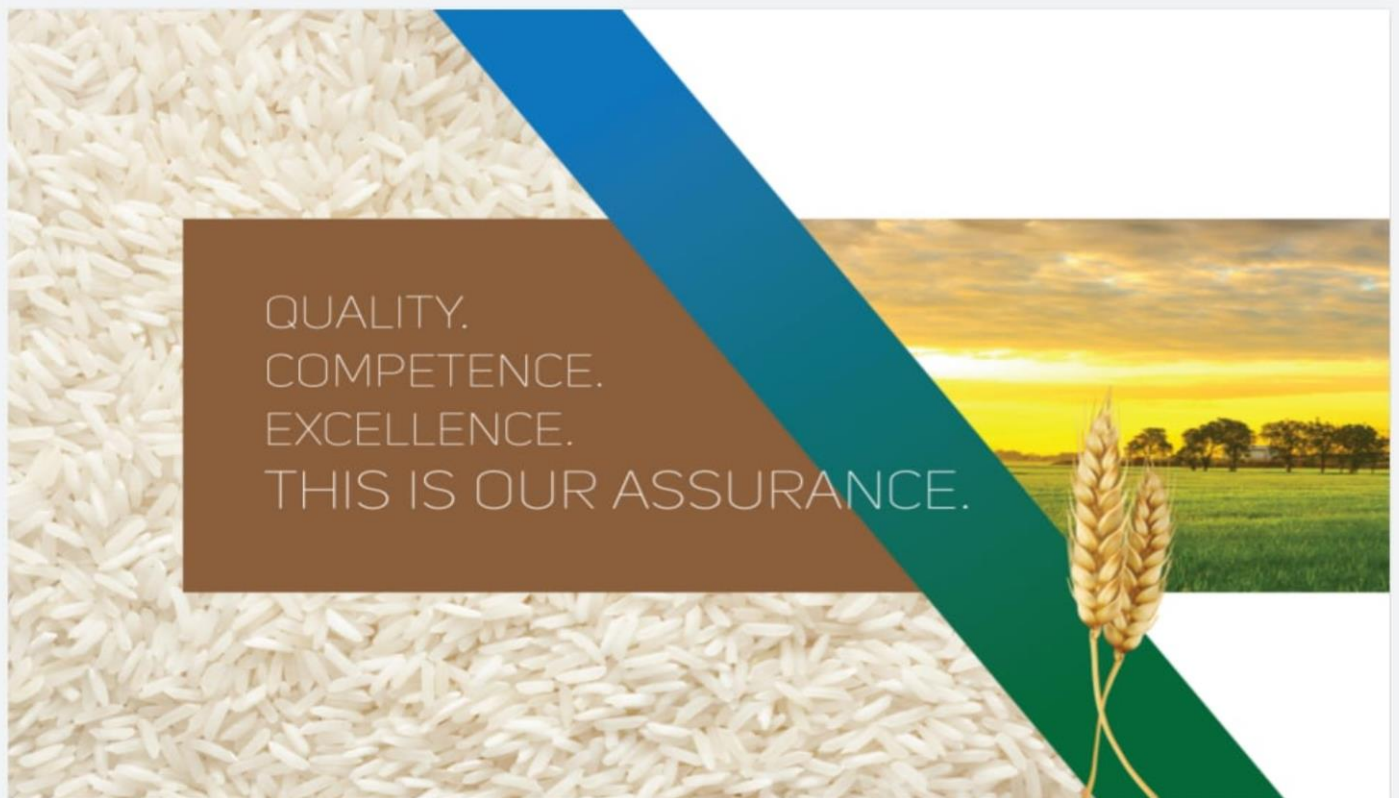

QUALITY.  
COMPETENCE.  
EXCELLENCE.  
THIS IS OUR ASSURANCE.

